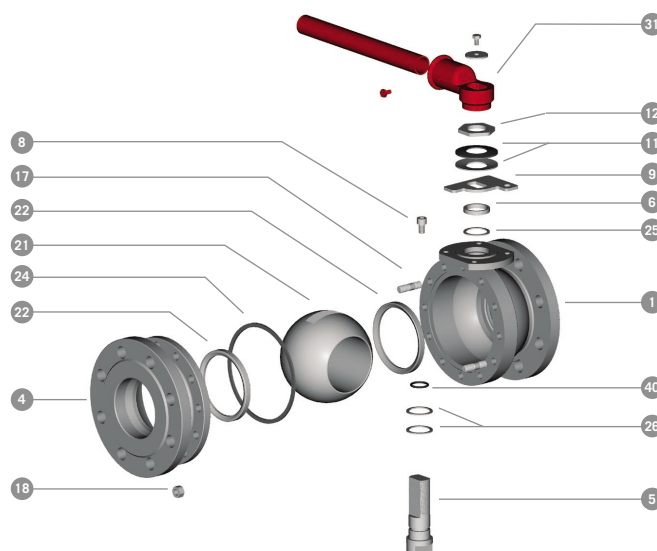
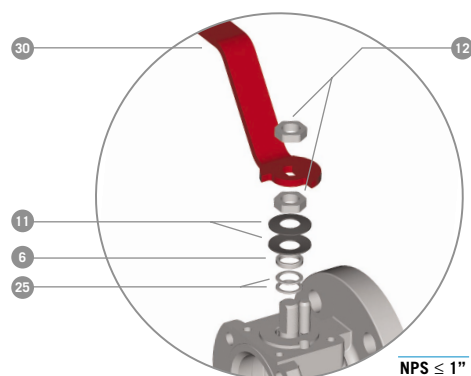

**MATERIALES ESTANDAR • STANDARD MATERIALS**

Grupo Cuerpo / Body Group			
Item	Componente / Component	Cod. SS	Cod. CS
1	Cuerpo / Body	ASTM A351 CF8M	ASTM A216 WCC* * WCC = WCB (0,25% C Máx.)
4	Terminal / Body Connector	ASTM A351 CF8M	ASTM A216 WCC* * WCC = WCB (0,25% C Máx.)
17	Espárrago-Tornillo / Stud Bolt-Bolt	<b>ANSI 150:</b> DN ≤ 8": DIN 267/11 A2-70 DN ≤ 8"+Nace: ASTM A193/A194 B7M/2HM deltatone coat. DN ≥ 10": ASTM A193/A194 B7M/2HM deltatone coated	ASTM A193/A194 B/M/2HM pavonado / blued
18	Tuerca / Nut	<b>ANSI 300:</b> DN ≤ 4": DIN 267/11 A2-70 DN ≤ 4"+Nace: ASTM A193/A194 B7M/2HM deltatone coat. DN ≥ 6": ASTM A193/A194 B7M/2HM deltatone coated <b>ANSI 600:</b> DN ≤ 2": DIN 267/11 A2-70 DN ≤ 2"+Nace: ASTM A193/A194 B7M/2HM deltatone coat. DN ≥ 3": ASTM A193/A194 B7M/2HM deltatone coated	
11	Arandela / Washer	Acero Inoxidable / Stainless steel (DIN 1.4122)	Acero pavonado / Blued steel
12	Tuerca / Nut	Acero Inoxidable / Stainless steel (DIN 267/11 A2-70)	DIN267/3 C 8.8 pavonado / blued
8	Tope / Stop Pin	Acero Inoxidable / Stainless steel (DIN 267/11 A2-70)	Acero / Steel
30-31	Palanca / Handle	DN ≤ 1": SS + Plastic DN > 1": GGG40	DN ≤ 1": Acero pintado / Steel coated DN > 1": GGG40
9	Indicador / Stop Plate	Acero niquelado / Steel nickel plated	Acero cincado / Steel zinc plated

Grupo Interno / Internal Group			
Item	Componente / Component	Cod. 316	Cod. 420
21	Esfera / Ball	DN ≤ 1": ASTM A479 316 DN ≥ 1 1/2": DIN 1.4408 (CF8M)	DN ≤ 2": <b>Cod. 316</b> 2" < DN < 10": DIN 1.4027 (CA15) DN ≥ 10": DIN 1.4408 (CF8M)
5	Eje Antiestático / Antistatic Stem	ASTM A479 316	DN ≤ 2": <b>Cod. 316</b> 2" < DN < 10": ASTM A479 410 DN ≥ 10": ASTM A479 316
6	Casquillo Prensa / Gland Ring	ASTM A479 316	ASTM A479 316

Grupo de Juntas / Seal Group			
Item	Componente / Component	Cod. PTFE	Cod. FSM
22	Asiento / Seat	PTFE	PTFE
24	Junta del Cuerpo / Body Seal	DN ≤ 1": PTFE DN ≥ 1 1/2": 316L + Flexite®	316L + Graphite
25	Estopada / Gland Packing	DN ≤ 1": PTFE + C + Graphite DN ≥ 1 1/2": PTFE	Graphite
26	Junta del Eje / Stem Seal	DN ≤ 1": PTFE + C + Graphite DN ≥ 1 1/2": PTFE	DN ≤ 1": PTFE + C + Graphite DN ≥ 1 1/2": PTFE
40	Tórico del Eje / Stem O'ring	FPM (Viton®)	FPM (Viton®)

**Acabado de Válvulas:** (CS) DN ≤ 6": fosfatadas y aceitadas.  
DN ≥ 8": imprimación base de 40 µm mín. (SS) Natural.

**Grupo accionador:** DN ≤ 6": con palanca. DN ≥ 8": con reductor manual.

**Valve Finish:** (CS) DN ≤ 6": phosphate and oil dipped.

DN ≤ 8": base priming 40 µm min. (SS) Natural

**Operation group:** DN ≤ 6": by wrench. DN ≤ 8": by gear box.