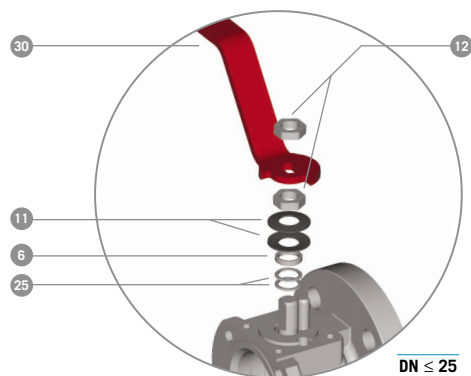
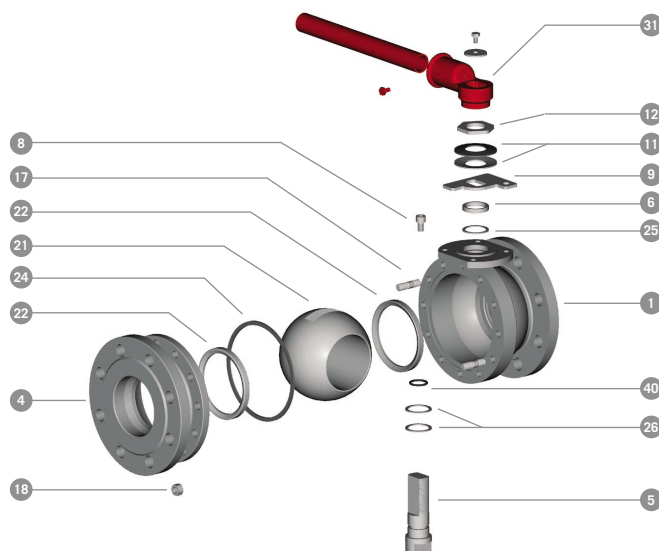

MATERIALES ESTANDAR • STANDARD MATERIALS

DN ≤ 25

Grupo Cuerpo / Body Group			
Item	Componente / Component	Cod. SS	Cod. CS
1	Cuerpo / Body	DIN 1.4408	DIN 1.0619
4	Terminal / Body Connector	DIN 1.4408	DIN 1.0619
17	Espárrago-Tornillo / Stud Bolt-Bolt	PN 10 - 16	PN 10 - 16 - 25 - 40
18	Tuerca / Nut	DN ≤ 250: DIN 267/11 A2-70 DN > 250: DIN 267/3 C 8.8 cincado / zinc plated	DIN 267/3/4 C 8.8/8 cincado / zinc plated
		PN 25 - 40	PN 63 - 100
		DN ≤ 150: DIN 267/11 A2-70 DN > 150: DIN 267/3 C 8.8 cincado / zinc plated	ASTM A193/A194 B7M/2HM pavonado / blued
		PN 63 - 100	
		DN ≤ 50: DIN 267/11 A2-70 DN > 50: ASTM A193/A194 B7M/2HM Deltatone coated	
11	Arandela / Washer	DIN 1.4122 (SS)	Acero cincado / Steel zinc plated
12	Tuerca / Nut	DIN 267/11 A2-70	DIN 267/3 C 8.8 pavonado / blued
8	Tope / Stop Pin	DIN 267/11 A2-70	Acero / Steel
30-31	Palanca / Handle	DN ≤ 25: SS + Plastic DN > 25: GGG40	DN ≤ 25: Acero pintado / Steel coated DN > 25: GGG40
9	Indicador / Stop Plate	Acero niquelado / Steel nickel plated	Acero cincado / Steel zinc plated

Grupo Interno / Internal Group			
Item	Componente / Component	Cod. 316	Cod. 420
21	Esfera / Ball	DN ≤ 32: ASTM A479 316 (1.4401) DN > 32: DIN 1.4408	DN ≤ 50: Cod. 316 50 < DN < 250: DIN 1.4027 DN ≥ 250: DIN 1.4408
5	Eje Antiestático / Antistatic Stem	ASTM A479 316 (1.4401)	DN ≤ 50: Cod. 316 50 < DN < 250: ASTM A479 410 (1.4021) DN ≥ 250: ASTM A479 316 (1.4401)
6	Casquillo Prensa / Gland Ring	ASTM A479 316 (1.4401)	ASTM A479 316 (1.4401)

Grupo de Juntas / Seal Group			
Item	Componente / Component	Cod. PTFE	Cod. FSM
22	Asiento / Seat	PTFE	PTFE
24	Junta del Cuerpo / Body Seal	DN ≤ 25: PTFE DN > 25: 316L + Flexite®	316L + Graphite
25	Estopada / Gland Packing	DN ≤ 25: PTFE + C + Graphite DN > 25: PTFE	Graphite
26	Junta del Eje / Stem Seal	DN ≤ 25: PTFE + C + Graphite DN > 25: PTFE	DN ≤ 25: PTFE + C + Graphite DN > 25: PTFE
40	Tórico del Eje / Stem O-ring	FPM (Viton®)	FPM (Viton®)

Acabado de Válvulas: (CS) DN ≤ 150: fosfatadas y aceitadas.
DN ≥ 200: imprimación base de 40 µm mín. (SS) Natural.

Grupo accionador: DN ≤ 150: con palanca. DN ≥ 200: con reductor manual.

Valve Finish: (CS) DN ≤ 150: phosphate and oil dipped.
DN ≥ 200: base priming 40 µm min. (SS) Natural.

Operation group: DN ≤ 150: by wrench. DN ≥ 200: by gear box.