

HB

Válvula Paso Total o Reducido y Cuerpo de una pieza.

Normas: • Diseño: BS5351 • Pruebas: BS6755 P1.

Conexiones: • Rosca NPT: Ansi B2.1 • Rosca BSP: DIN259

• SW: Ansi B 16.11 • BW: SW + Nipples Sch 40-80 (Ansi B 16.25).

Para conocer las combinaciones de Gama, se recomienda acceder a este apartado, y para una descripción más detallada, solicitar Planos Comerciales a KCE.

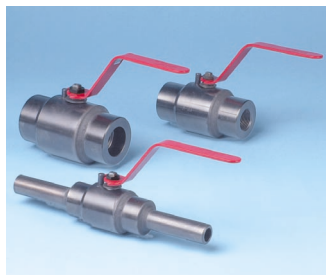

HB

Full or Reduced Bore valve, 1-piece body construction.

Standards: • Design: BS5351 • Test: BS6755 P1.

Connections: • NPT thread: Ansi B2.1 • BSP thread: DIN259

• SW: Ansi B16.11 • BW: SW + Nipples Sch 40-80 (Ansi B16.25).

If you want to get acquainted with the Range combinations, see this section. For a more detailed description, ask KCE for the Commercial Drawings.

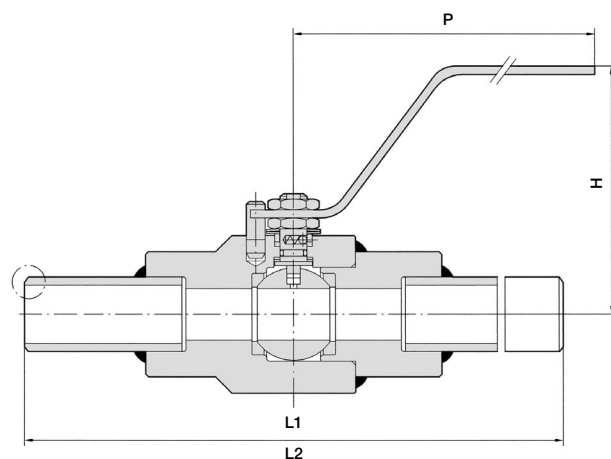
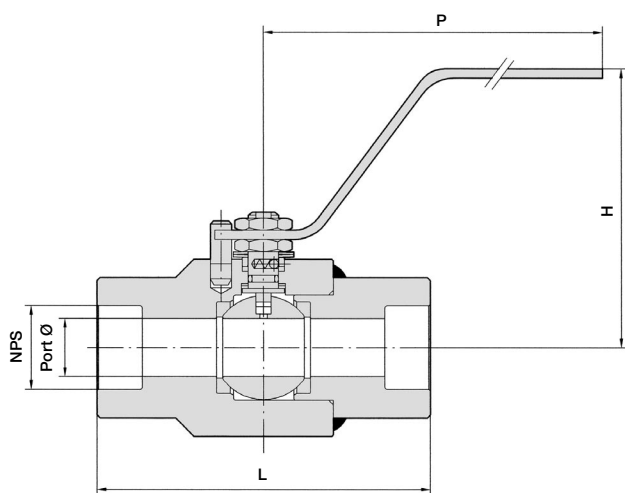

Class 800

| NPS | | Port | Dimensiones / Dimensions | | | | | | Cv ⁽¹⁾ | | Par / Torque ⁽¹⁾ | | | Peso / Weight | | |
|--------|--------|------|--------------------------|----------------|----------------|-----|-----|-----------|-------------------|----|-----------------------------|---------|---------|---------------|-------------------|-------------------|
| RB | FB | | L | L ₁ | L ₂ | H | P | SW Sch ØA | RB | FB | 50 bar | 100 bar | 140 bar | (L) | (L ₁) | (L ₂) |
| - | 1/4" | 12,5 | 90 | 240 | 400 | 53 | 150 | - | 14,1 | - | 12 | 8 | 9 | 10 | 1,1 | 1,2 |
| - | 3/8" | | 90 | | | 85 | | - | 17,7 | - | 12 | 8 | 9 | 10 | 1,2 | 1,4 |
| 3/4" | 1/2" | | 90 | | | 90 | | 27,4 | 21,8 | 7 | 34 | 10 | 12 | 15 | 1,3 | 1,6 |
| 1" | 3/4" | 19 | 110 | 260 | 400 | 90 | 200 | 34,1 | 27,4 | 20 | 34 | 10 | 12 | 15 | 1,6 | 1,9 |
| - | 1" | 25 | 120 | | | 100 | | - | 34,1 | - | 50 | 15 | 20 | 20 | 2,4 | 2,8 |
| 1 1/2" | - | 32 | 130 | | | 105 | | 49 | - | 55 | - | 20 | 25 | - | 3,4 | 3,8 |
| 2" | 1 1/2" | 38 | 150 | 260 | 400 | 110 | 350 | 61 | 49 | 90 | 120 | 25 | 35 | - | 5,6 | 6,2 |
| - | 2" | 51 | 180 | | | 116 | | - | 61 | - | 250 | 35 | 50 | - | 8,8 | 11,2 |

⁽¹⁾ Ver pares de maniobra. / See torque values.

Ejecución / Execution BW = SW + Nipple

| NPS | ØM | Sch 10S | | Sch 40S | | Sch 80 | | Sch 160 | |
|---------|------|--------------------|------|---------------------|------|---------------------|------|--------------------|------|
| | | ØN | ØR | ØN | ØR | ØN | ØR | ØN | ØR |
| 1/2" | 21,3 | - | 17,1 | - | 15,8 | - | 13,9 | 15,0 | 11,8 |
| 3/4" | 26,7 | - | 22,5 | - | 21,0 | - | 18,9 | 18,8 | 15,6 |
| 1" | 33,4 | 31,1 | 27,9 | 29,8 | 26,6 | 27,5 | 24,3 | 23,9 | 20,7 |
| 1 1/2" | 48,3 | 46,0 | 42,8 | 44,1 | 40,9 | 41,3 | 38,1 | 37,2 | 34,0 |
| 2" | 60,3 | 58,0 | 54,8 | 55,7 | 52,5 | 52,4 | 49,2 | 46,1 | 42,9 |
| Cod. SS | | Especial / Special | | Estándar / Standard | | | | | |
| Cod. CS | | | | | | Estándar / Standard | | Especial / Special | |

