

Probball KH 2T F ball valves of all sizes are also available with pneumatical, electrical, or hydraulic actuators.

Flanged ball valve
full bore, design acc. to KLINGER
material code Xc,
face to face
acc. to EN 558-1,
GR. 1 (DIN 3202-F1);
acc. to EN 558-1,
GR. 27 (DIN 3202-F4);
flanges acc. to EN 1092 (DIN 2501)

Specification:

Two-piece ball valve, flanges acc. to EN 1092 (DIN 2501), face to face dimensions acc. to EN 558-1, GR. 1/GR. 27 (DIN 3202-F1/-F4), full bore, blow-out-proof stem, body material stainless steel (ASTM A351-CF8M/DIN 1.4408), anti-static device, seat PTFE 25 % glassfibre reinforced, stem packing PTFE, disc spring loaded acc. to German clean air act adjustable, floating ball, free of non-ferrous metals, approved by PED, top flange DIN/ISO 5211, safety spring locking device is optional.

Marking: RK-Probball

Type: KH 2T F-Xc

No.	Part	Material code
1	body	1.4408 = AISI 316
2	cap	1.4408 = AISI 316
3	ball	1.4408 = AISI 316
4	seat	PTFE 25 % gf
5	seal	PTFE
6	thrust washer	PTFE gf
7	stem packing	PTFE
8	stem	1.4401 = AISI 316
9	ring	1.4401 = AISI 316
10	belleville washer	1.4310 = AISI 301
11	nut	1.4301 = AISI 304
12	screw	A4 - 70
12.1	stud bolt F4, DIN 3202	A4 - 70
12.2	nut F4, DIN 3202	A4 - 70
13	stop pin	1.4301 = AISI 304
14	handle	1.4301 = AISI 304
15	insulation cover	Vinyl
16	spring locking device (special type)	1.4301 = AISI 304
17	antistatic element	1.4401 = AISI 304
18	locking washer	1.4301

Top flange

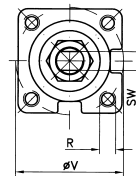

DN (mm)	V	R	SW
15	42x	M 5x 0,8	8
20	42x	M 5x 0,8	8
25	50x	M 6x 1,0	10
32	50x	M 6x 1,0	10
40	50x	M 6x 1,0	10
50	70x	M 8x 1,25	14
65	70x	M 8x 1,25	14
80	102x	M 10x 1,5	19
100	102x	M 10x 1,5	19

Dimensions

DN mm	DN inch	PN	dimensions (mm)				top flange	torque Nm	weight kg		
			H	I	L F1	F4				PN 16	PN 40
15	1/2	-	40	85	160	130	115	F04	9	-	2,1
20	3/4	-	40	92	160	150	120	F04	10	-	3,0
25	1	-	40	106	173	160	125	F05	19	-	4,3
32	1 1/4	-	40	110	210	180	130	F05	33	-	5,8
40	1 1/2	-	40	116	210	200	140	F05	40	-	6,8
50	2	-	40	136	275	230	150	F07	65	-	11,0
65	2 1/2	16	40	150	275	290	170	F07	70	16,0	17,8
80	3	16	40	185,5	370	310	180	F10	90	19,0	22,7
100	4	16	40	200	370	350	190	F10	140	32,0	33,0

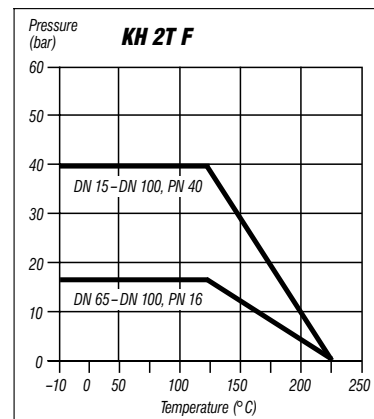

ordering example: KH 2T F-Xc, DN 65,
PN 16, F1