

# FLOWSEAL-Butterfly Valves Series VIA/MS

## Model GA

### Materials / Temperature range

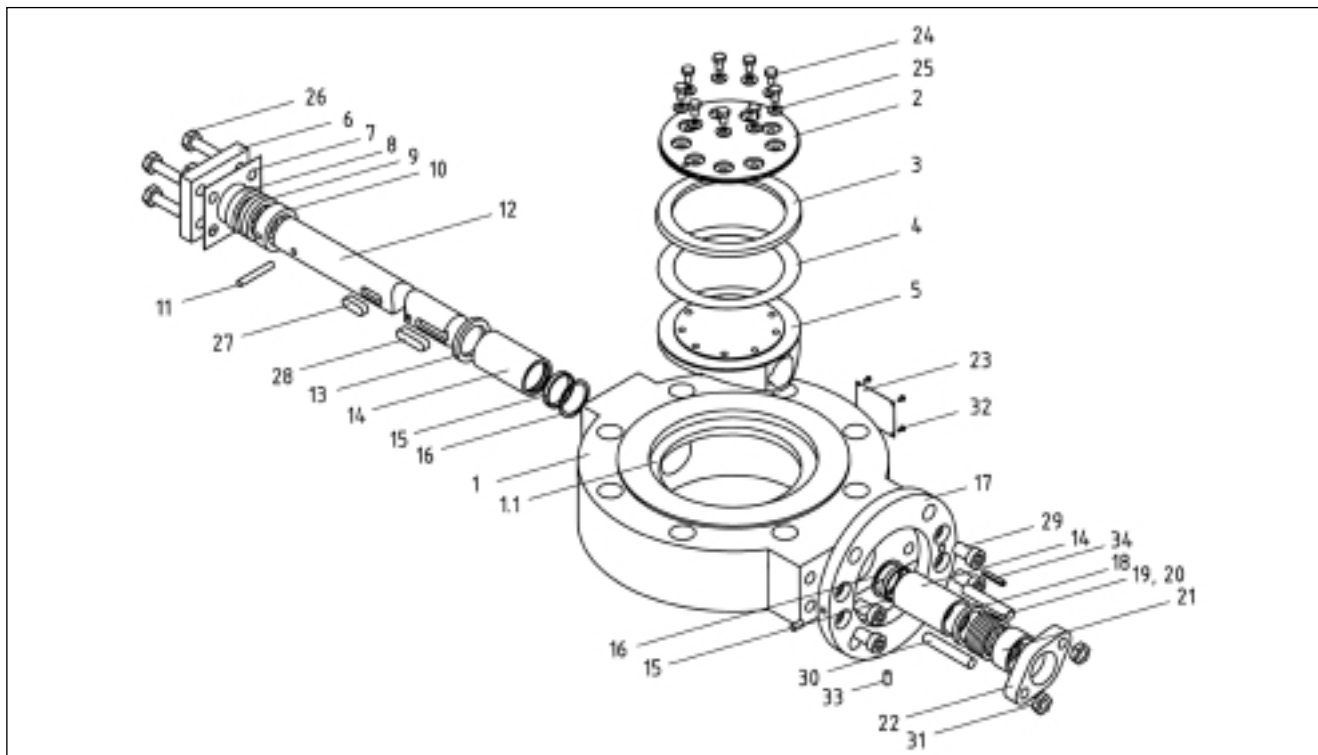

Item	Model No. Part	Steel version *2		Stainless steel version*2		
		-10°C bis +400°C (14°F to 752°F) -B11200F Standard	-10°C bis +300°C (14°F to 572°F) -B11A00F Nace	-10°C bis +400°C (14°F to 752°F) -H11300F Standard	-10°C bis +300°C (14°F to 572°F) -H11400F Nace	-60°C bis +550°C (-76°F to 1022°F) -H11500F High and low temperature
1	Body*	A216 WCB/A516 Gr. 60		A351 CF8M / A240 Type 321		
1.1	Body seat*	1.4571 or similar (Stellite on request)		1.4552 / 1.4541 (Stellite on request)		
2	Seal retainer ring *	P265GH / P250GH (nickel-plated)		1.4541		
3	Laminated seal	1.4541 / Graphite		1.4541 / Graphite		
4	Gasket	Graphite		Graphite		
5	Disc *	A216 WCB / P265GH / P250GH (nickel-plated)		A351 CF8M / A240 Type 321		
6	Cover	P265GH		1.4541		
7	Cover gasket	Graphite		Graphite		
8	Intermediate ring	1.4305		1.4305		
9	Ring	Graphite		Graphite		
10	Shaft retainer	1.4305 hard-chromium-plated		1.4305 hard-chromium-plated		
11	Pin	1.4571 or equivalent		1.4571 or equivalent		
12	Shaft	1.4057	1.4462	1.4057	1.4462	1.4980
13	Thrust ring	1.4112 / 1.4034 (hardened)		1.4112 / 1.4034 (hardened)		
14	Bushing	1.4305 (coated)		1.4305 (coated)		
15	Bearing protector	Carbon fiber mesh		Carbon fiber mesh		
16	Anti seize ring	-		1.4112 / 1.4034 (hardened)		
17	Mounting plate	Steel		Steel, nickel-plated		
18	Ring	1.4305		1.4305		
19	Gland packing	Carbon fiber mesh		Carbon fiber mesh		
20	Gland packing	Graphite		Graphite		

\* Material according to the manufacturer's choice

\*2 The application type (medium / temperature) has to be specified when ordering

To be continued on the next page

Item	Temperature range  Model No. Part	Steel version * <sup>2</sup>		Stainless steel version* <sup>2</sup>		
		-10°C bis +400°C (14°F to 752°F) -B11200F Standard	-10°C bis +300°C (14°F to 572°F) -B11A00F Nace	-10°C bis +400°C (14°F to 752°F) -H11300F Standard	-10°C bis +300°C (14°F to 572°F) -H11400F Nace	-60°C bis +550°C (-76°F to 1022°F) -H11500F High and low temperature
21	Gland bushing	1.4305		1.4305		
22	Gland flange	P265GH		1.4541		
23	Name plate	Stainless steel		Stainless steel		
24	Screw	A2 - 70		A2 - 70		1.4980
25	Spring washer *	1.4923 / 1.4122	Inconel	1.4923 / 1.4122	Inconel	1.4980
26	Screw	A2 - 70		A2 - 70		1.4980
27	Disc key	1.4571		1.4571		
28	Drive key	1.4571		1.4571		
29	Screw	A2 - 70		A2 - 70		1.4980
30	Stud	A2 - 70		A2 - 70		1.4980
31	Nut	A2 - 70		A2 - 70		1.4980
32	Round head grooved pin	Stainless steel		Stainless steel		
33	Groove pin (mounting plate)	Galvanized steel		Galvanized steel		
34	Roll pin	Galvanized steel		Galvanized steel		

\* Material according to the manufacturer's choice

\*<sup>2</sup> The application type (medium / temperature) has to be specified when ordering

We reserve the right for changes to all technical specifications.

# FLOWSEAL-Butterfly Valves Series VIA/MS

## Model GA - Lug Body API 609

ANSI key way

### Dimensions / Weights DN 80 - 600

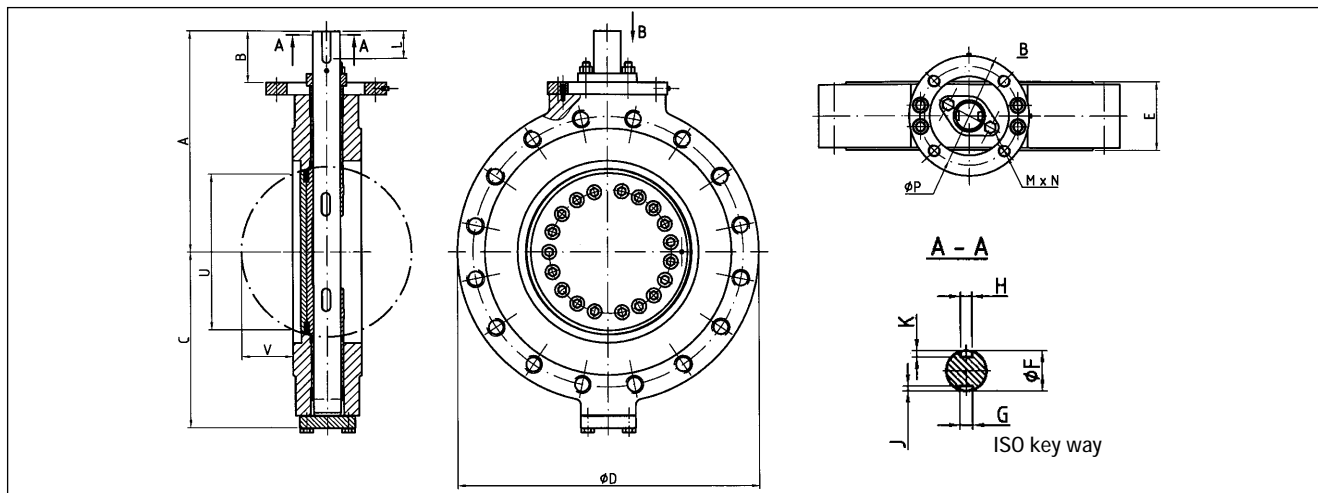

### Dimensions in mm, bare shaft end

DN	80	100	150	200	250	300	350	400	450	500	600
	3"	4"	6"	8"	10"	12"	14"	16"	18"	20"	24"
A	192	207	252	303	339	367	407	476	533	575	657
B (ANSI 150)	62	62	72	80	80	85	90	113	120	130	140
B (ANSI 300)	62	62	72	80	80	85	90	113	120	130	120
C	130	145	180	208	240	292	317	383	433	465	537
D (ANSI 150)	190	240	280	343	406	482	533	597	635	698	813
D (ANSI 300)	210	240	318	381	444	520	584	648	711	774	914
E (ANSI 150)	48	54	57	64	71	81	92	102	114	127	154
E (ANSI 300)	48	54	59	73	83	92	117	133	149	159	181
F	20	22	32	38	40	45	55	65	70	75	90
G	6	6	10	10	12	14	16	18	20	20	25
H	4.8	4.8	8	9.5	9.5	12.7	12.7	15.9	19.1	19.1	22.3
J	3.5	3.5	5	5	5	5.5	6	7	7.5	7.5	9
K	2.7	2.7	4.5	5.4	5.4	7.3	7.1	9	10.9	10.8	12.6
L	22	22	32	40	40	45	50	63	70	80	90
M	4	4	4	4	4	4	4	8	8	8	8
N	7/16-14 UNC		5/8-11 UNC		3/4-10 UNC			5/8-11 UNC			
P	125 F12		140 F14		165 F16			254 F25			
U (ANSI 150)	72	96	146	191	239	287	326	366	409	457	559
U (ANSI 300)	72	96	144	187	234	281	315	353	396	446	545
V (ANSI 150)	20	31	55	73	93	114	129	144	159	173	219
V (ANSI 300)	31	31	53	65	84	103	109	121	137	156	194

### Weights in kg

DN	80	100	150	200	250	300	350	400	450	500	600
	3"	4"	6"	8"	10"	12"	14"	16"	18"	20"	24"
<b>bare shaft</b>											
ANSI 150	15	20	28	46	66	82	94	132	249	319	545
ANSI 300	15	20	29	52	77	83	120	172	325	400	770
<b>with gear</b>											
ANSI 150	29	34	42	65	92	108	121	189	320	391	635
ANSI 300	29	34	50	78	103	147	176	258	436	512	973

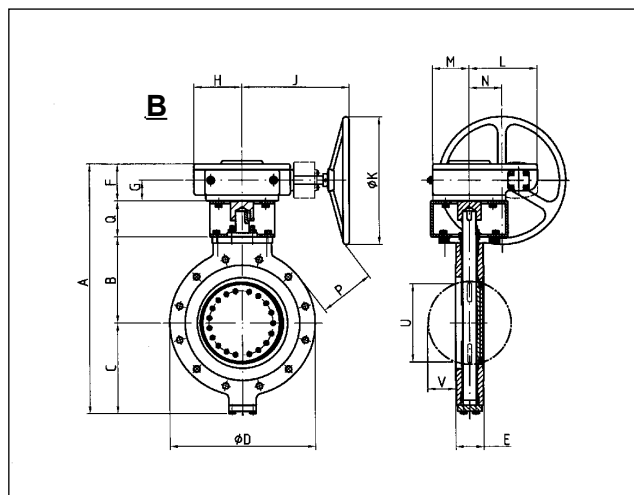
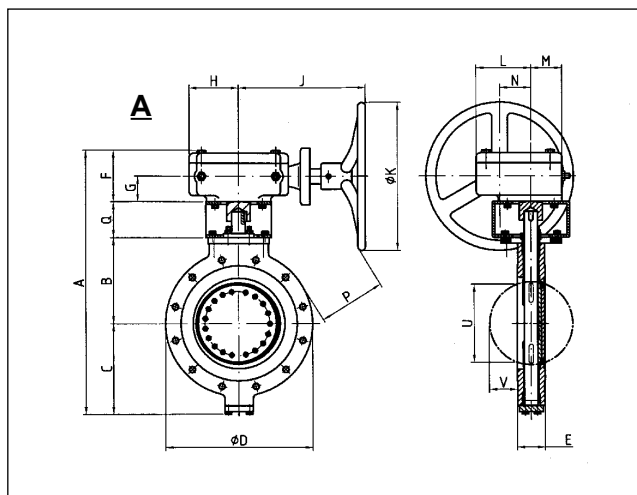

### Dimensions in mm, with manual gear

DN	80 3"	100 4"	150 6"	200 8"	250 10"	300 12"	350 14"	400 16"
ΔP max (psi)	715	715	285 715	230 715	570 715	230 360 715	230 360 570 715	145 360 570 715
A	416	446	526 530	627 631	699 699	774 800 821	834 860 881 906	1006 1032 1078 1076
B	130	145	180	223	259	282	317	363
Q	80	80	90	120	120	120	120	180
F	76	76	76 80	76 80	80 106	80 106 127	80 106 127 152	80 106 152 150
G	42	42	42 44.5	42 44.5	44.5 50	44.5 50 50	44.5 50 50 66	44.5 50 66 64
H	64	64	64 100	64 100	100 126	100 126 158	100 126 158 155	100 126 155 153
J	240	240	240 282	240 282	282 362	282 362 387	282 362 387 493	282 362 493 509
K	250	250	250 400	250 400	400 600	400 600 600	400 600 600 600	400 600 600 600
L	98	98	98 134	98 134	134 178	134 178 209	134 178 209 232	134 178 232 239
M	45	45	45 64	45 64	64 114	64 114 117	64 114 117 158	64 114 158 171
N	65	65	65 96.4	65 96.4	96.4 123	96.4 123 154	96.4 123 154 60	96.4 123 60 68
P (ANSI 150)	159	142	148 -	169 150	141 -	118 133 -	118 123 - -	169 151 - -
P (ANSI 300)	149	142	129 127	150 131	122 143	99 114 137	92 97 120 222	143 126 241 253
Drawing	A	A	A A	A A	A B	B B B B	B B B B	B B B B

DN	450 18"				500 20"					600 24" (cl.150)		
ΔP max (psi)	145	230	360	675	145	230	360	570	715	230	360	715
A	1082	1103	1128	1226	1196	1217	1242	1240	1254	1386	1384	1418
B	413				445					517		
Q	180				180					180		
F	106	127	152	150	106	127	152	150	164	152	150	164
G	50	50	66	64	50	50	66	64	70	66	64	70
H	126	158	155	153	126	158	155	153	175	155	153	175
J	362	387	493	509	362	387	493	509	464	493	509	464
K	600	600	600	600	600	600	600	600	600	600	600	600
L	178	209	232	239	178	209	232	239	175	232	239	175
M	114	117	158	171	114	117	158	171	326	158	171	326
N	123	154	60	68	123	154	60	68	153	60	68	153
P(150)	167	184	196	-	158	175	264	-	-	255	265	-
P(300)	129	146	158	237	120	137	226	238	207	204	215	224
Drawing	B	B	B	B	B	B	B	B	B	B	B	B

Note:

- Dimensions C, D, E, U, V see front page  
-14,5 psi ≅ 1 bar

We reserve the right for changes to all technical specifications.